

Wessex Fleet

Boat Layouts



**WESSEX
NARROWBOATS**

The Wessex Boat fleet operates exclusively from Hilperton Marina (see pages 24-25 for details of the routes). Each of the Wessex boats have been individually designed and built providing 5 unique boat layouts suitable for between 2 to 6 people. Wessex

Elaine & Morgaine have saloons that can provide either cross doubles or two single berths. All the Wessex boats have been Tourist Board rated between 3 and 5 stars when the saloon is not used as a berth at night.

Wessex Elaine 2+2 Berth Length 47ft. Sleeps up to 4

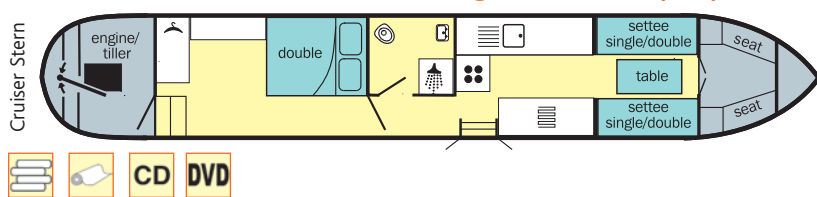

BASES	Fri/ Mon	Sat	Sun
Hilperton	✓		
Price Code:	B		

Wessex Morgaine 2+2 Berth Length 50ft. Sleeps up to 4

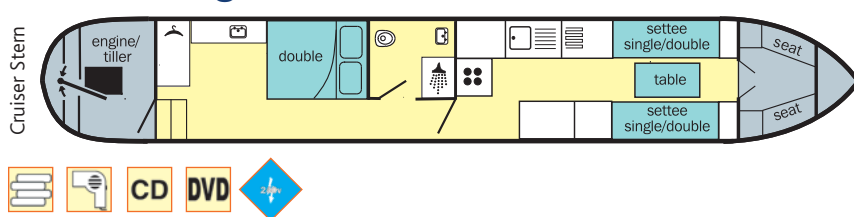

BASES	Fri/ Mon	Sat	Sun
Hilperton	✓		
Price Code:	C		

Wessex Gawaine 4+2 Berth Length 62ft. Sleeps up to 6

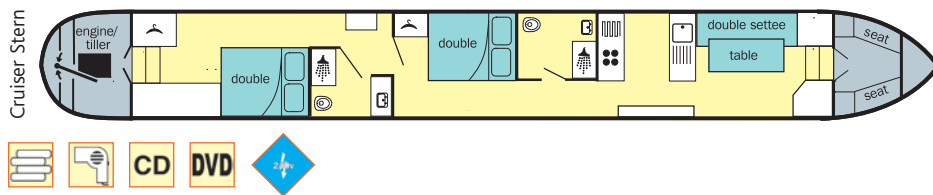

BASES	Fri/ Mon	Sat	Sun
Hilperton		✓	
Price Code:	G		

Wessex Empress 4+2 Berth Length 58ft. Sleeps up to 6

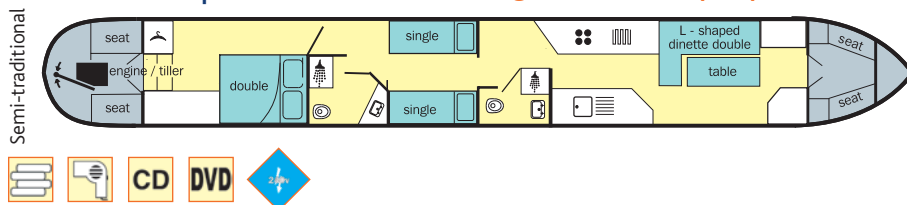

BASES	Fri/ Mon	Sat	Sun
Hilperton		✓	
Price Code:	G		

Wessex Accolon 4+2 Berth Length 60ft. Sleeps up to 6

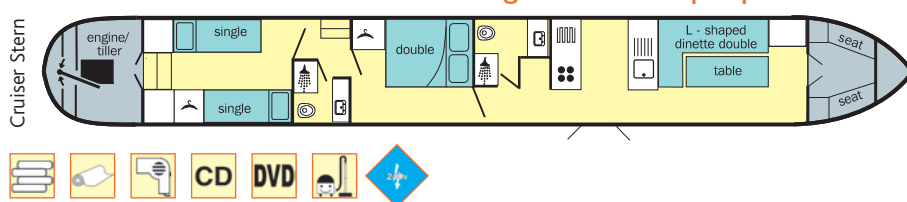

BASES	Fri/ Mon	Sat	Sun
Hilperton	✓		
Price Code:	H		



UK BOAT HIRE